

NFE094 Revised March 10 , 1999  
(Replaces 3/1/99)  
© 1998,1999 Senco Products, Inc.  
8485 Broadwell Rd.  
Cincinnati, Ohio 45244

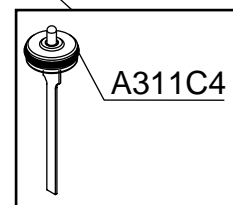



**REPLACEMENT PARTS LIST**  
**LISTA DE PARTES DE REPUESTO • LISTE DE PIÉCES DE RECHANGE**

<u>PART NO.</u>	<u>DESCRIPTION</u>	<u>DESCRIPCIÓN</u>	<u>DÉSIGNATION</u>
A20004	SCREW	TORNILLO	VIS
A20021	SCREW	TORNILLO	VIS
A20346	SCREW	TORNILLO	VIS
A20505	WASHER	ARANDELA	RONDELLE
A20634	PIN	PASADOR	GOUPILLE
A20667	PIN	PASADOR	GOUPILLE
A20675	PIN	PASADOR	GOUPILLE
A21002	SPRING	RESORTE	RESSORT
A21081	SPRING	RESORTE	RESSORT
A21091	SPRING	RESORTE	RESSORT
A210A5	SPRING	RESORTE	RESSORT
A23230	CYLINDER	CILINDRO	CYLINDRE
A23321	DEFLECTOR	DESVIADOR	DÉFLECTEUR
A23403	RETAINER	RETÉN	RETENUE
A27626	GUIDE	GUIA	GUIDE
A27828	SPACER	SEPARADOR	ENTRETOISE
A29562	PLATE	PLACA	PLAQUE
A30501	RETAINER	RETÉN	RETENUE
A30503	RETAINER	RETÉN	RETENUE
A31100	SEAL	SELLO	JOINT
A311C4	SEAL	SELLO	JOINT
A311C5	SEAL	SELLO	JOINT

<u>PART NO.</u>	<u>DESCRIPTION</u>	<u>DESCRIPCIÓN</u>	<u>DÉSIGNATION</u>
A31110	SEAL	SELLO	JOINT
A31167	SEAL	SELLO	JOINT
A31180	SEAL	SELLO	JOINT
A31400	MUFFLER	SILENCIADOR	SILENCIEUX
A33102	COVER	CUBIERTA	COUVERCLE
A33505	COVER	CUBIERTA	COUVERCLE
A34127	STOP	TOPE	ARRÊT
A34209	BUSHING	CASQUILLO	DOUILLE
A34328	SEAL	SELLO	JOINT
A34341	WASHER	ARANDELA	RONDELLE
A35012	TRIGGER	GATILLO	GÂCHETTE
A37701	LATCH	UÑETA	DOIGT DE RETENUE
B23119	VALVE	VÁLVULA	VALVE
B24014	VALVE	VÁLVULA	VALVE
B50027	VALVE	VÁLVULA	VALVE
BS30110	PISTON ASSEMBLY	ASAMBLE DE PISTON	ENSEMBLE PISTON-COUTEAU
E15227	LABEL	ETIQUETA	ETIQUETTE
	(SAFETY PRECAUTIONS)	(NORMAS DE SEGURIDAD)	(PRÉCAUTIONS DE SÉCURITÉ)
KSC29	PLATE	PLACA	PLAQUE
KSC33	MAGAZINE	CARGADOR	MAGASIN
PC0479	PLUG	RETÉN	EMBOUT